

VARIANTS					
DESCRIPTION	PART NUMBER	D1	D2	D3	D4
3X2 EDUCTOR ASSY, TC	C0015-01-3200	3	2	5.07	7.50
4X2 EDUCTOR ASSY, TC	C0015-01-4200	4	2	6.45	9.00
4X3 EDUCTOR ASSY, TC	C0015-01-4300	4	3	7.18	9.00
6X3 EDUCTOR ASSY, TC	C0015-01-6300	6	3	8.73	12.75
6X4 EDUCTOR ASSY, TC	C0015-01-6400	6	4	8.72	12.75
3X2 EDUCTOR ASSY, BW	C0015-02-3200	3	2	4.45	5.19
4X2 EDUCTOR ASSY, BW	C0015-02-4200	4	2	5.08	6.88
4X3 EDUCTOR ASSY, BW	C0015-02-4300	4	3	7.14	6.88
6X3 EDUCTOR ASSY, BW	C0015-02-6300	6	3	8.73	11.25
6X4 EDUCTOR ASSY, BW	C0015-02-6400	6	4	8.72	11.25

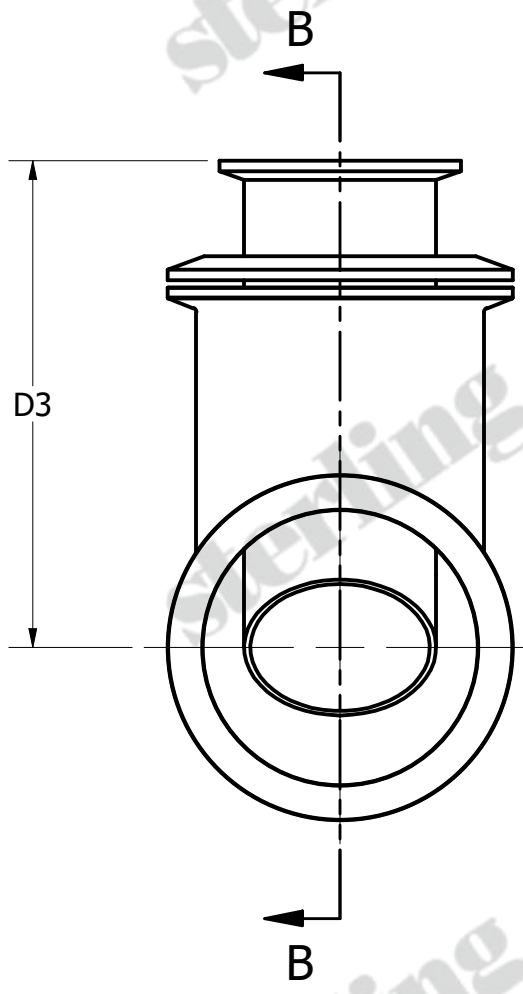

SECTION B-B
SCALE 1 / 2

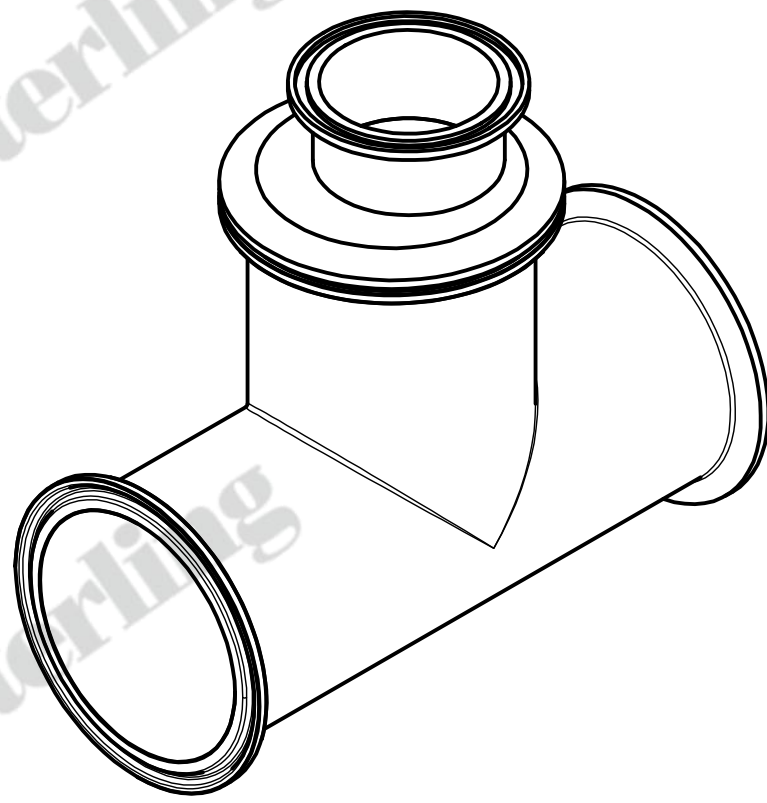
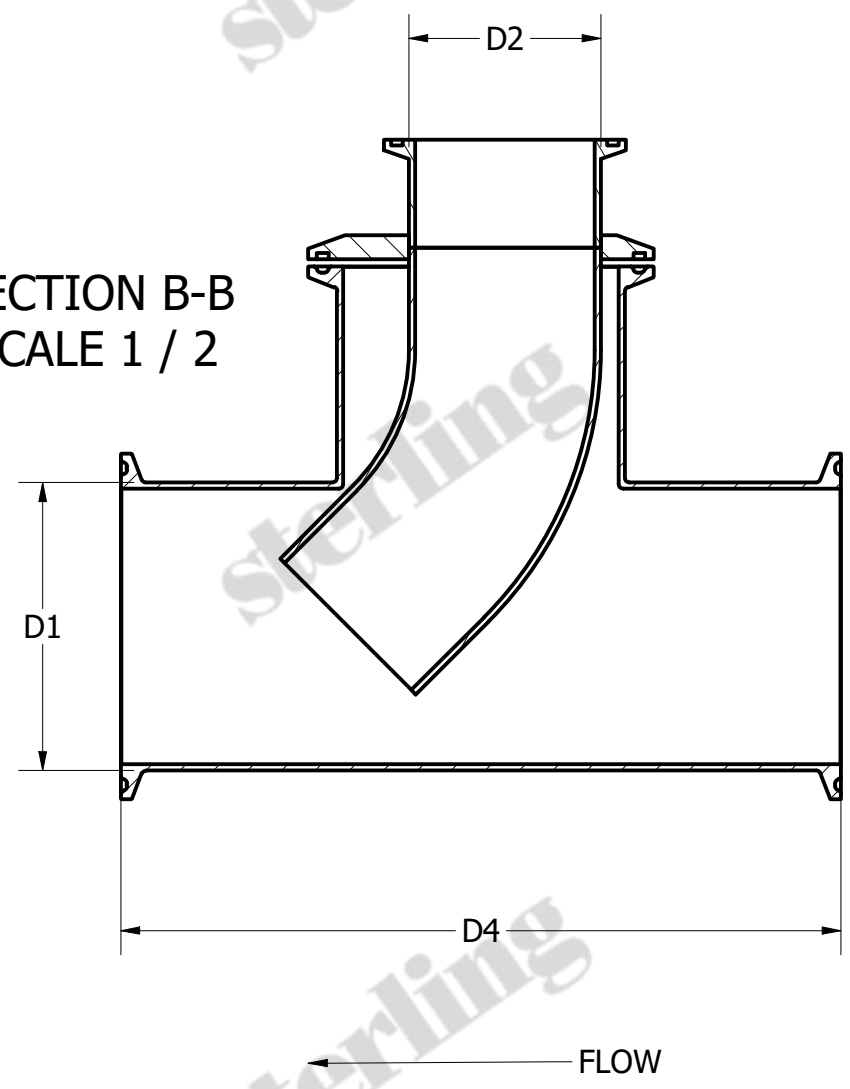

- NOTES:
 1. GASKETS/CLAMPS SOLD SEP.
 2. MATERIAL: 316SS

sterling
 Process Equipment and Services, Inc.

333 McCormick Blvd
 Columbus, Ohio 43213-1526
 Ph: (614) 868-5151 (800) 783-7875
 www.sterlingpe.com sales@sterlingpe.com

EDUCTOR PRODUCT LINE

EDUCTOR ASSY

Project Mgr: nkopycynsk
 Drawn By: nkopycynsk
 Checked By: XXXX
 Scale: NTS
 Date: 3/31/2021

C0015-0X-XX00

The information, data and drawings embodied in this document are the ownership of Sterling Process Engineering and Services, Inc. and shall not be disclosed to third parties without prior written consent of Sterling Process Engineering and Services, Inc.